

ACTUAL SIZE

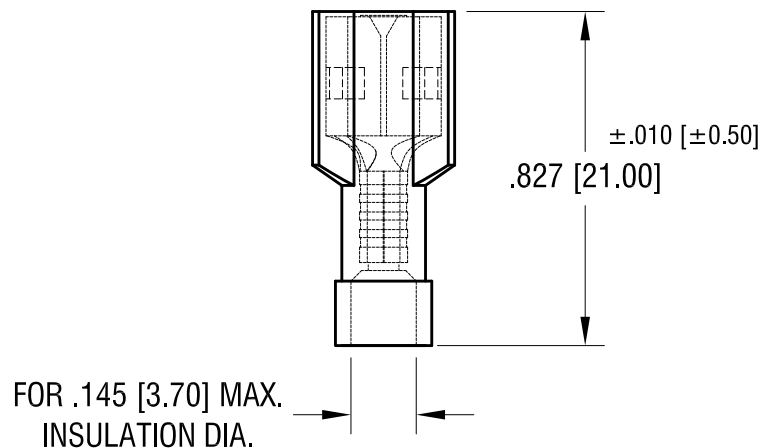
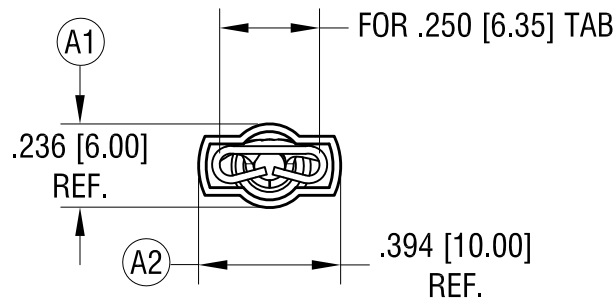
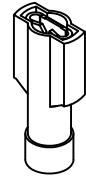

NOTE:

1. TERMINAL: MATES WITH MALE TAB
.250 [6.35] x .032 [0.81] TH'K
MATERIAL: BRASS, TIN PLATE
INSULATOR: NYLON 6/6, RED
2. ACCOMMODATES WIRE RANGE 22/18 AWG

10.05.23	NEW TOOLING CHANGE AS PER ECN 23-191	C	KEYSTONE ELECTRONICS CORP. www.keyelco.com • NEW HYDE PARK, NY 11040 • Tel (516) 328-7500			
8.04.21	TERMINAL MAT'L WAS COPPER CHANGE AS PER ECN 21-078	B	PART NAME FULLY INSULATED QUICK-FIT TERMINAL			
			MATERIAL AS NOTED			
12.29.14	SPLIT C/M TO 'C' & 'M' A1 A2 WAS ABSOLUTE ±.015 CHANGE AS PER ECN 14-129	A	FINISH AS NOTED	DRN BY NT	DATE 6.09.09	
				APP'D RH	SCALE 2X	
DATE	DESCRIPTION	REV.	TOLERANCES INCH [MM] DECIMAL ±.015 [±0.38] ANGULAR ± 1° UNLESS OTHERWISE SPECIFIED	CODE C	DWG NO. 8292	