

ACTUAL SIZE

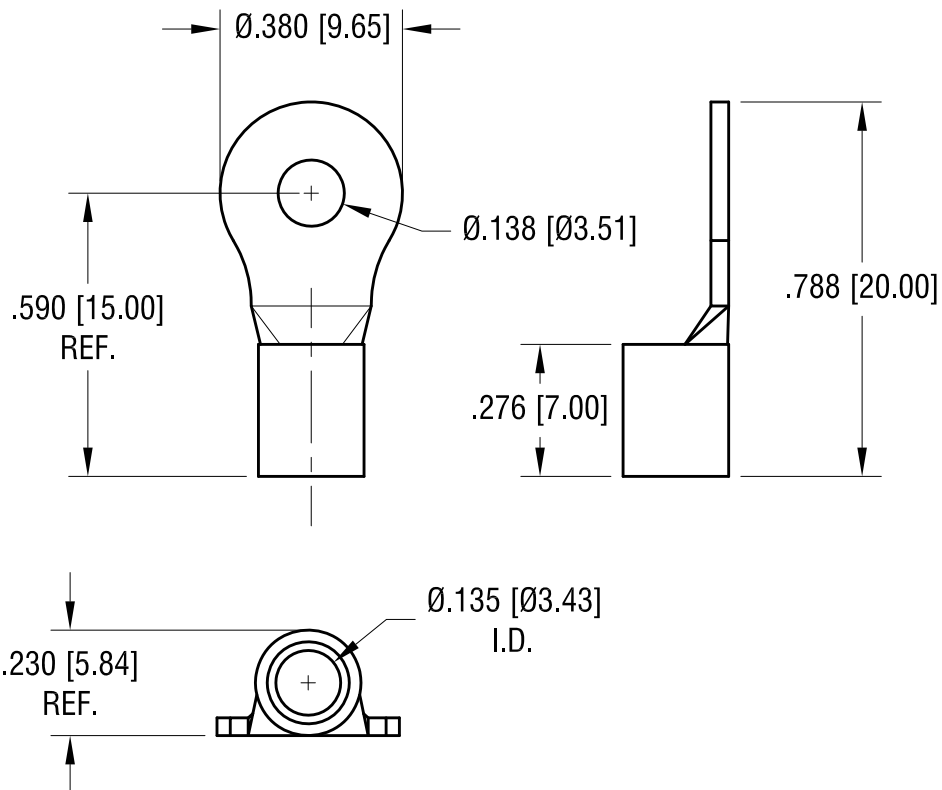

NOTE:

1. ACCOMMODATES WIRE RANGE 12/10 AWG

9.22.23	CHANGE AS PER ECN 23-168	B
3.15.23	(A1) WAS $.290 \pm .010$ CHANGE AS PER ECN 23-039	A
DATE	DESCRIPTION	REV.

KEYSTONE ELECTRONICS CORP.			
www.keyelco.com • NEW HYDE PARK NY 11040 • Tel (516)328-7500			
PART NAME			
RING TONGUE TERMINAL			
MATERIAL			
.040 [1.02] TH'K COPPER			
FINISH		DRN BY	DATE
TIN PLATE		BOONE	10.17.07
		APP'D	SCALE
		RH	2.5X
TOLERANCES	INCH [MM]	CODE	DWG NO.
DECIMAL	$\pm .015$ [± 0.38]	C	8206
ANGULAR	$\pm 1^\circ$		
UNLESS OTHERWISE SPECIFIED			