



Quality Products. Service Excellence.

Eclipse DIN Rails *DR Series*



- Field installable.
- Includes a set of 3 plated rails.
- Available in 3 industry standard profiles - DIN 1, DIN 3, and CENELEC.
- **DIN rail mounting kit** required for installation.
- Rails have an oblong slot on each end for ease of mounting.
- Zinc plated.

Accessories

- Eclipse DIN Rail Mounting Kit

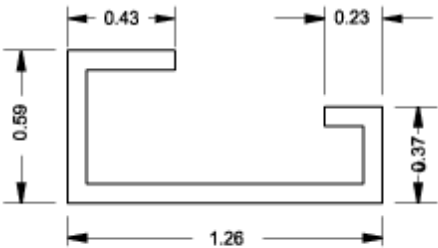

Asymmetric DIN 1 Pro

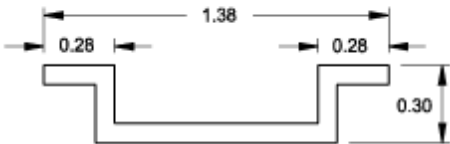

Symmetric DIN 3 Pro

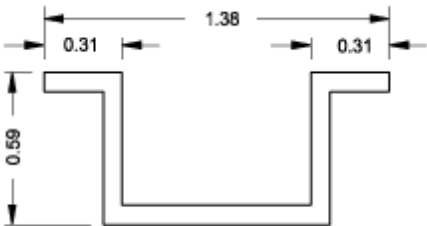

CENELEC Pro

AsymmetricDIN 1 Profile Part No.	Symmetric DIN 3 Profile Part No.	Cenelec Profile Part No.	Length
2D1K12	2D2K12	2DCK12	9.75
2D1K16	2D2K16	2DCK16	13.75
2D1K20	2D2K20	2DCK20	17.75
2D1K24	2D2K24	2DCK24	21.75
2D1K30	2D2K30	2DCK30	27.75

Tags: **DIN**, **DIN rail**, **din 1**, **din 3**, **cenelec**, **rails**, **eclipse**

*Data subject to change without notice*

© 2024. Hammond Manufacturing Ltd. All rights reserved.