



Part Number

ERA.0S.304.CLL

Size/Series 0S / S

[Request a quote](#)

#### MECHANICAL DETAILS

**Shell Style/Model** ERA\*: Fixed receptacle, nut fixing  
**Keying** Hermaphroditic keying ("half moon" insert), plug has male pin 1  
**Housing Material** Brass (chrome plated) shell and collet nut, nickel plated brass latch sleeve and mid pieces  
**Cable Fixing**  $\emptyset$  : 0 - 0 mm  
**Variant** :

	A	B	E	L	L2	M	S1	S3	e
mm.	10	12.4	7	17.5	18.0	1.2	8.2	11	M9x0.6
in.	0.39	0.49	0.28	0.69	0.71	0.05	0.32	0.43	

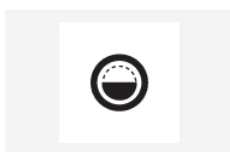
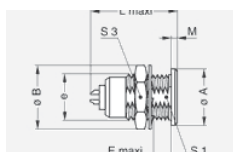

#### PERFORMANCE DETAILS

**Insert Configuration** 0S.304 : 4 Low Voltage  
**Insulator** L: PEEK  
**Specifications**  
**Contact Type:** Solder  
**Max. Matings:** 5000  
**Contact Dia.:** 0.7 mm (0.028in)  
**Bucket Dia.:** 0.6 mm (0.024in)  
**Max. Solid Conductor:** 0.25 mm<sup>2</sup> (AWG 24)  
**Max. Stranded Conductor:** 0.14 mm<sup>2</sup> (AWG 26)  
**R (max):** 6.1 mOhm  
**Vtest:** 1060 V (AC), 1500 V (DC)  
**Rated Current:** 7 A (AC/DC)

#### OTHER CHARACTERISTICS

**Endurance (Shell)** 3839 mating cycles  
**Humidity (max):** <=95% [at 60 deg C /140 F]  
**Vibration:** 15 g [10 Hz - 2000 Hz]  
**Shock Resistance:** 100 g [6 ms]  
**Salt Spray Corrosion:** >144 hr  
**Climatical Category:** 50/175/21  
**Shielding (min):** 75 dB (10 MHz)  
**Shielding (min):** 40 dB (1 GHz)  
**IP Rating** 50  
**Catalog**



[Download 3D draw](#)