

SPECIFICATIONS:

<b>MATERIALS:</b>	
BACKSHELL:	THERMOPLASTIC
ALIGNMENT SLEEVE:	TIN PLATED STEEL
COVER:	TIN PLATED STEEL
INSULATOR (MATING END):	THERMOPLASTIC
INSULATOR (REAR END):	THERMOPLASTIC
#2-56 THUMBSCREW:	NICKEL PLATED STEEL

<b>ELECTRICAL:</b>	
RATED CURRENT:	1A
D.W.V.:	500V for 1min

<b>ENVIRONMENT:</b>	
OPERATING TEMPERATURE:	-10°C TO +70°C

MATING CYCLES:	300
MAXIMUM DISCRETEWIRE JACKET OD:	0.039"

BACKSHELL KIT INCLUDES:

- 1x - BACKSHELL
- 1x - ALIGNMENT SLEEVE
- 1x - COVER
- 1x - INSULATOR (MATING END)
- 1x - INSULATOR (REAR END)
- 2x - #2-56 THUMBSCREW

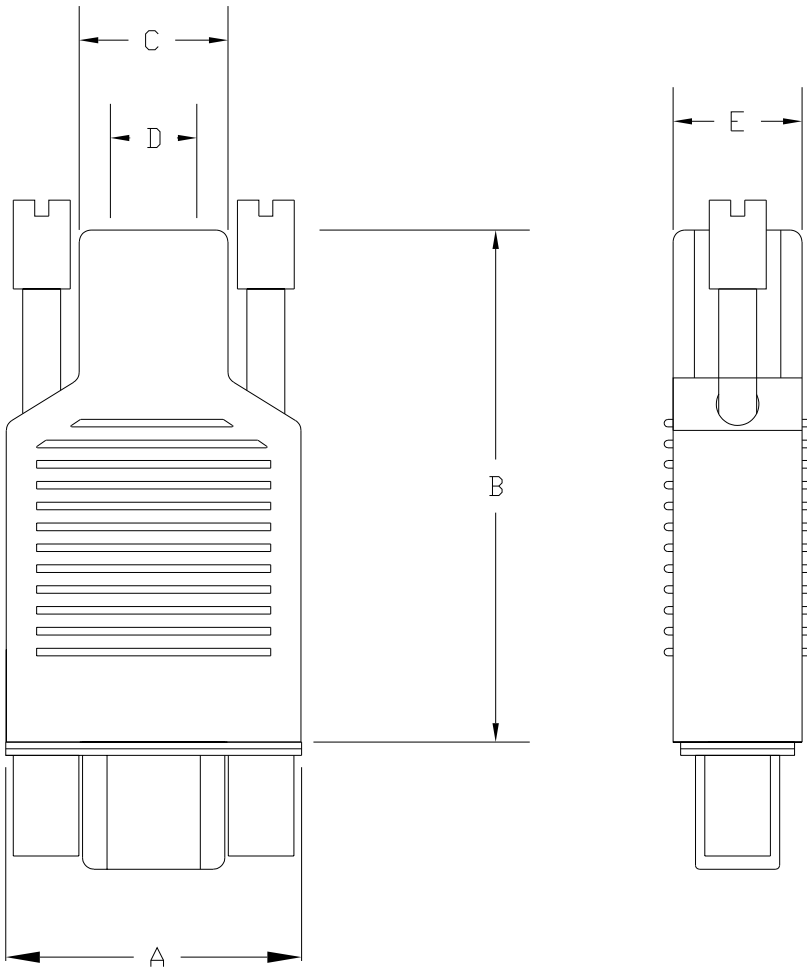

		DIMENSIONS				
No. OF PINS	UNITS	A	B	C	D MAX	E
9	inch	0.780	1.350	0.395	0.228	0.338
	mm	19.81	34.29	10.03	5.79	8.59
15	inch	0.932	1.367	0.360	0.284	0.338
	mm	23.67	34.72	9.14	7.21	8.59
25	inch	1.195	1.373	0.390	0.331	0.390
	mm	30.35	34.87	9.91	8.41	9.91

960-YYY-010R01Y

1 = KIT  
2 = BULK

009 = 9 POSITION  
015 = 15 POSITION  
025 = 25 POSITION

**NOTE:**

\*CONTACTS MUST BE PURCHASED SEPARATELY (part numbers below):

- 960-001-170L005 (reeled contacts)
- 960-101-170L005 (loose contacts)
- 960-702-170-00 (crimp tool)

**NOTE:**

\*\*NOT DESIGNED TO MATE WITH NORCOMP 580-M // 581-M SERIES CONNECTORS.  
IF ANY QUESTIONS PLEASE CONTACT ENG@NORCOMP.NET

RoHS COMPLIANT



THESE DRAWINGS AND SPECIFICATIONS ARE THE PROPERTY OF NorComp AND SHALL NOT BE REPRODUCED, COPIED OR USED AS THE BASIS FOR THE MANUFACTURE OR SALE OF APPARATUS WITHOUT WRITTEN PERMISSION.

DRAWN:  
M. SIGMON

DATE:  
09/01/2011

UNITS = "as indicated" DO NOT SCALE FROM DRAWING

NorComp

SCALE:  
NTS

SHEET  
1 OF  
2

REV  
9

DWG NO. 960-YYY-010R01Y

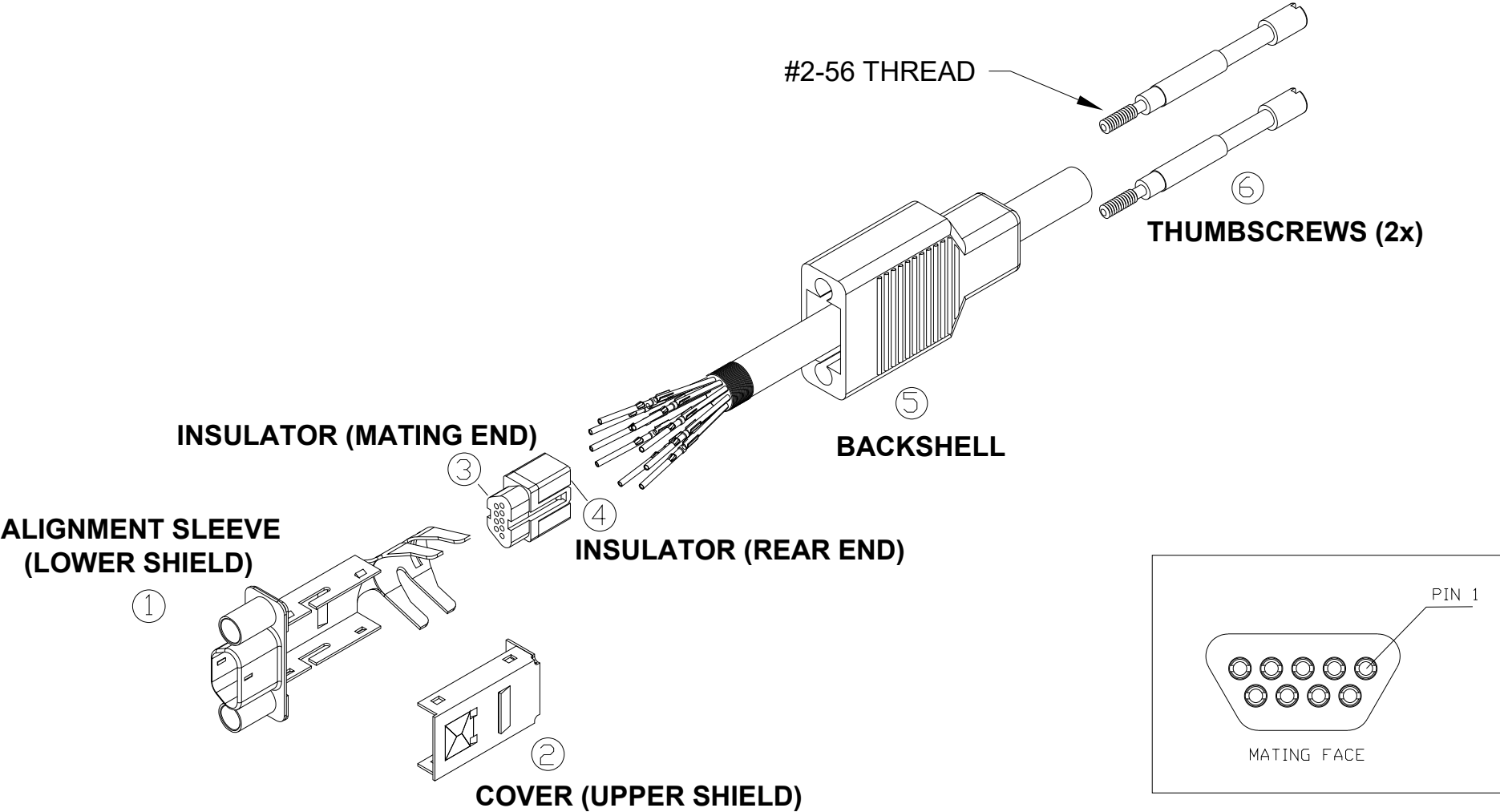

RoHS COMPLIANT

DO NOT SCALE FROM DRAWING



THESE DRAWINGS AND SPECIFICATIONS ARE THE PROPERTY OF NorComp AND SHALL NOT BE REPRODUCED, COPIED OR USED AS THE BASIS FOR THE MANUFACTURE OR SALE OF APPARATUS WITHOUT WRITTEN PERMISSION.

DRAWN: M. SIGMON

DATE: 09/01/2011

NorComp	SCALE: NTS	SHEET 2 OF 2	REV 9
	DWG NO. 960-YYY-010R01Y		