

<b>APPLICABLE STANDARD</b>					
RATING	OPERATING TEMPERATURE RANGE	-35°C TO +85°C (NOTES 1)	STORAGE TEMPERATURE RANGE	-10°C TO +60°C	
	VOLTAGE	30V AC	APPLICABLE CONNECTOR	BM10*(0.8)-20DS-0.4V(*)	
	CURRENT	0.3A			
<b>SPECIFICATIONS</b>					
ITEM		TEST METHOD	REQUIREMENTS	QT	AT
<b>CONSTRUCTION</b>					
GENERAL EXAMINATION		CONFIRMED VISUALLY AND BY MEASURING INSTRUMENT.	ACCORDING TO DRAWING.	X	X
MARKING		CONFIRMED VISUALLY.		X	X
<b>ELECTRIC CHARACTERISTICS</b>					
CONTACT RESISTANCE		20mV AC OR LESS 1kHz, 1mA	100mΩ MAX.	X	—
INSULATION RESISTANCE		100V DC.	50MΩ MIN.	X	—
VOLTAGE PROOF		100V AC FOR 1 min.	NO FLASHOVER OR BREAKDOWN.	X	—
<b>MECHANICAL CHARACTERISTICS</b>					
INSERTION AND WITHDRAWAL FORCES		MEASURED BY APPLICABLE CONNECTOR.	INSERTION FORCE 24.3N MAX WITHDRAWAL FORCE 4.4N MIN	X	—
MECHANICAL OPERATION		10 TIMES INSERTIONS AND WITHDRAWAL.	① CONTACT RESISTANCE: 100mΩ MAX. ② NO DAMAGE, CRACK OR LOOSENESS OF PARTS.	X	—
VIBRATION		FREQUENCY 10 TO 55 TO 10 Hz, APPROX 5min, SINGLE AMPLITUDE 0.75 mm, 10 CYCLES, FOR 3 DIRECTIONS.	① NO ELECTRICAL DISCONTINUITY OF 1 μs. ② NO DAMAGE, CRACK OR LOOSENESS OF PARTS.	X	—
SHOCK		490 m/s <sup>2</sup> DURATION OF PULSE 11 ms AT 3 TIMES FOR 3 DIRECTIONS.	① NO ELECTRICAL DISCONTINUITY OF 1 μs. ② NO DAMAGE, CRACK OR LOOSENESS OF PARTS.	X	—
<b>ENVIRONMENTAL CHARACTERISTICS</b>					
RAPID CHANGE OF TEMPERATURE		TEMPERATURE -55 → +85 °C TIME 30 → 30 min UNDER 5 CYCLES. (RELOCATION TIME TO CHAMBER: WITHIN 2 ~3 MIN)	① CONTACT RESISTANCE: 100mΩ MAX. ② INSULATION RESISTANCE: 50MΩ MIN. ③ NO DAMAGE, CRACK OR LOOSENESS OF PARTS.	X	—
DAMP HEAT (STEADY STATE)		EXPOSED AT 40 ± 2 °C, 90 TO 95 %, 96 h.	① CONTACT RESISTANCE: 100mΩ MAX. ② INSULATION RESISTANCE: 25MΩ MIN. ③ NO DAMAGE, CRACK OR LOOSENESS OF PARTS.	X	—
SULPHUR DIOXIDE		EXPOSED IN 25 PPM FOR 96h, 25°C, 75%. (REFER TO JIS C 60068)	① CONTACT RESISTANCE: 100mΩ MAX. ② NO DAMAGE, CRACK OR LOOSENESS OF PARTS.	X	—
	COUNT	DESCRIPTION OF REVISIONS	DESIGNED	CHECKED	DATE
△					
REMARKS			APPROVED	KH. IKEDA	09.09.03
NOTE1: INCLUDE THE TEMPERATURE RISING BY CURRENT			CHECKED	TS. MIYAZAKI	09.09.03
			DESIGNED	SH. HOSODA	09.09.02
Unless otherwise specified, refer to JIS C 5402 and IEC 60512			DRAWN	SH. HOSODA	09.04.27
Note QT:Qualification Test AT:Assurance Test X:Applicable Test			DRAWING NO.		ELC4-317784-75
<b>HRS</b>	SPECIFICATION SHEET		PART NO.	BM10B (0.8)-20DP-0.4V (75)	
	HIROSE ELECTRIC CO., LTD.		CODE NO.	CL684-6009-0-75	△ 1/1

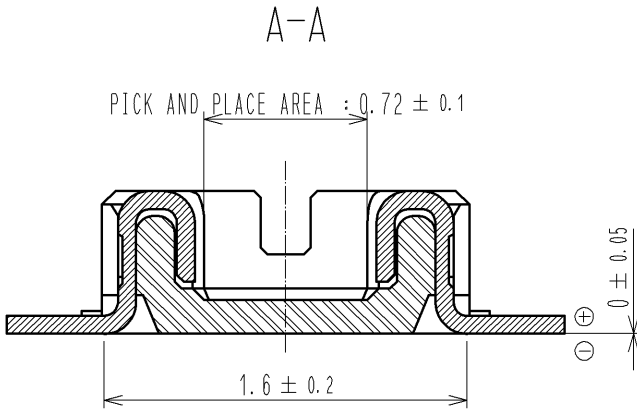

RECOMMENDED PATTERN

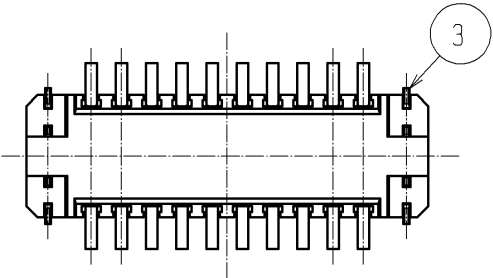
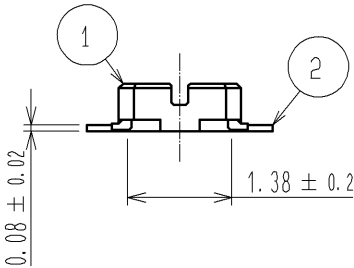
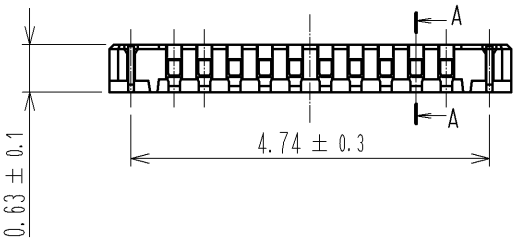
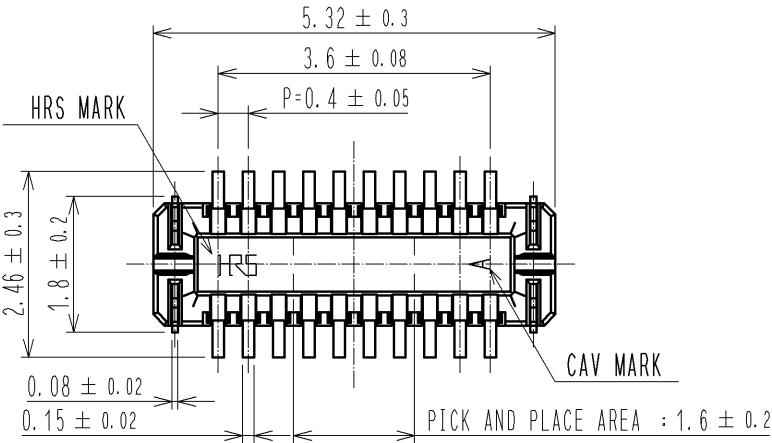
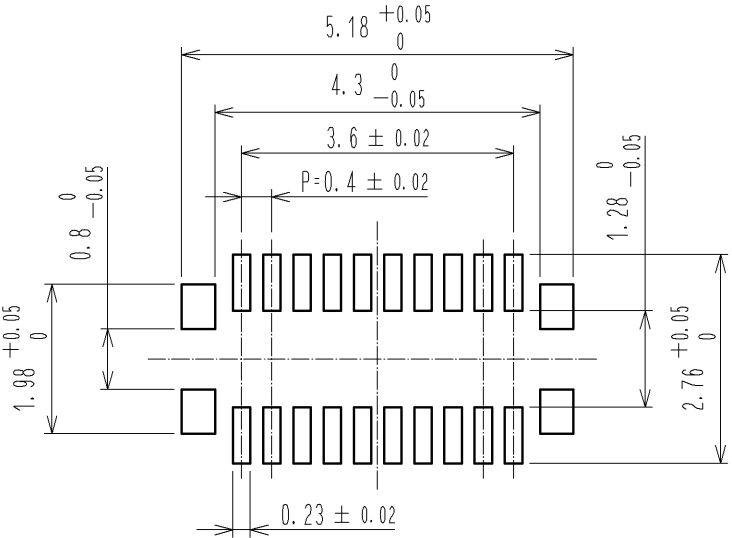

RECOMMENDED SOLDER PASTE:THICKNESS 120μm

ENGAGEMENT FIGURE

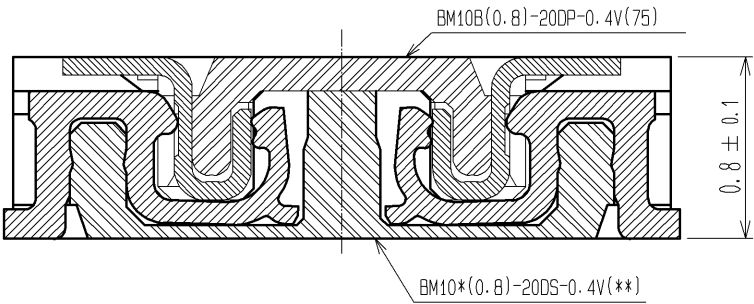

- NOTE 1. ALL LEADS CO-PLANARITY SHALL BE 0.1 MAX.

2. PER REEL : 8000 CONNECTORS.

3. AT THE BEGINNING OF THE REEL, 100 mm AT MIN SHALL BE EMPTY POCKETS.

AT THE END OF THE REEL, 160 mm AT MIN SHALL BE EMPTY.

4 CONTACT PLATING SPECIFICATIONS.

CONTACT AREA : GOLD 0.1μm MIN.

SMT LEAD : GOLD 0.05μm MIN.

UNDERPLATING : NICKEL 1μm MIN.

(SURFACE : SEALING)
- 5 METAL HOLD DOWN PLATING SPECIFICATIONS.

MOUNTING AREA: GOLD 0.05μm MIN.

UNDERPLATING : NICKEL 1μm MIN.

6. PEEL FORCE OF COVER TAPE REFERS TO JIS C 0806.

3	PHOSPHOR BRONZE		6	PS	PLASTIC REEL (BLACK)				
2	PHOSPHOR BRONZE		5	POLYESTER	CLEAR(COVER TAPE)				
1	LCP	UL94V-0. BLACK	4	PS	CLEAR(EMBOSSED CARRIER TAPE)				
NO.	MATERIAL	FINISH , REMARKS		NO.	MATERIAL	FINISH , REMARKS			
UNITS mm		SCALE 10 : 1		COUNT	DESCRIPTION OF REVISIONS		DESIGNED	CHECKED	DATE
HIROSE ELECTRIC CO., LTD.		APPROVED : KH. IKEDA		09.09.03	DRAWING NO.		EDC3-317784-75		
		CHECKED : TS. MIYAZAKI		09.09.03	PART NO.		BM10B(0.8)-20DP-0.4V(75)		
		DESIGNED : SH. HOSODA		09.08.31	CODE NO.		CL684-6009-0-75		
		DRAWN : SH. HOSODA		09.04.24			1/2		

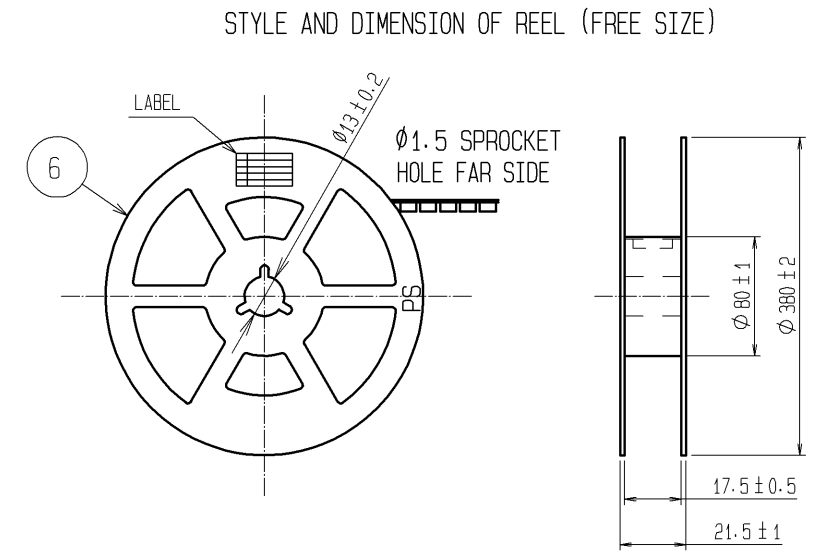

SUPPLIER	
QUANTITY	
PART NO.	
CODE NO.	
DATE OF MANUFACTURED	
生産月日	年 月 日
図番	CL684-6009-0-75
品名	BM10B(0.8)-20DP-0.4V(75)
納入数量	8000個
納入者	ヒロセ電機(株)

<b>HRS</b>	DRAWING NO. EDC3-317784-75	
	PART NO. BM10B<0.8>-20DP-0.4V<75>	
	CODE NO. CL684-6009-0-75	△ 2/2